

# Protect

User Manual

## Protect 7300/7400/7500/7700 Series

Product name:	Model number:	Model number:
10-models	100-127V	220-240V
7310i	7331371000	7331371000
7410i	7411371000	7421371000
7510i	7511371000	7521371000
7710i	7711371000	7721371000
40-models		
7340i	7332371000	7332371000
7440i	7412371000	7422371000
7540i	7512371000	7522371000
7740i	7712371000	7722371000
70-models		
7370i	7333371000	7333371000
7470i	7413352000	7423352000
7475i	7413352000	7423352000
7570i	7513352000	7523352000
7770i	7713352000	7723352000
7775i	7713352000	7723352000

Please read this user manual carefully and keep it for future reference.  
The latest version of this user manual can be found on [www.blueair.com](http://www.blueair.com)

Note: There may be local variations of these models.

## Content

Protect	4
Safety instructions	6
Get started	8
Control panel	9
Filters	19
Move the air purifier	21
Cable winder	21
Care and maintenance	22
Troubleshooting	23
Disposal and recycling	24
Help and support	24
Warranty information	24
Specification	25
Regulatory information	26

# Protect

Protect air purifiers are available in three models, the 10-models, the 40-models and the 70-models. All models are Wi-Fi enabled, have a GermShield™ function to prevent bacterial growth, pre-filters and a main filter to purify air.

All Protect models have control functions and built in sensors. The 40-models and the 70-models have additional indications for air quality data. The 40-models have a display for particulate matter data. The 70-models have a dynamic screen control, with additional functions for particles, gases (tVOC), temperature, relative humidity and filter lifetime.

You can change the air purifier settings at any time, using the control panel on the air purifier or remotely using the Blueair app. Additional functions are available for all models through the Blueair app.

## Recommendations for best performance

- Use the air purifier in a room that does not exceed the room size recommendation.
- Place the air purifier in a location where air can circulate freely in, out and around the air purifier.
- Do not place the air purifier closer than 10cm/4" to another object.
- During operation, keep doors and windows in the room with the air purifier closed.
- Run the air purifier 24 hours per day with the GermShield™ function on.
- Only use original Blueair filters.
- Change the main filter when the filter replacement indicator appears on the control panel.
- Follow the maintenance instructions in this user manual.

Blueair air purifiers are mainly composed of a motor, a fan and a filter. The air purifier removes contaminants from the air in a room to improve indoor air quality.

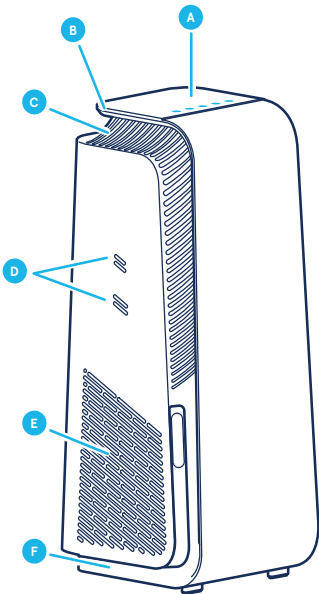

- A** Control panel
- B** Handle
- C** Air outlet
- D** Air quality sensor inlets
- E** Air inlet
- F** Feet and wheels\*

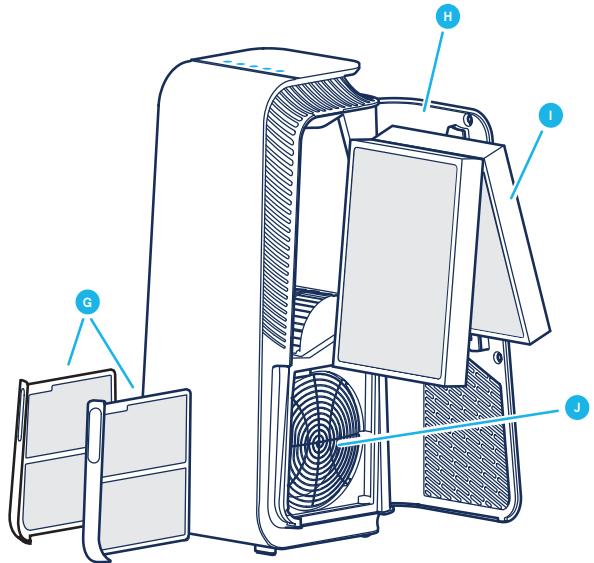

- G** Pre-filters
- H** Filter door
- I** Main filter
- J** Fan and motor
- K** Power cable (not in picture)
- L** User Manual (not in picture)

\*Not available on 7300-models

# Safety instructions

**Protect** air purifiers are electrical appliances for indoor use only, take the necessary precautions to reduce the risk of fire, electric shock or injury.

- This appliance is not intended for use by persons (including children) with reduced physical, sensory or mental capabilities, or lack of experience and knowledge, unless they have been given supervision or instruction concerning use of the appliance by a person responsible for their safety.
- Children should be supervised to ensure that they do not play with the appliance.
- Always disconnect the appliance from the power supply before maintenance.
- If your Blueair appliance is found to be defective, we will replace it with the same or a similar model at no cost, per the warranty terms. Please use caution attempting repairs yourself, as this presents the danger of electrical shock or injury.
- Ensure that the power cable and the power plug are not at risk of getting damaged.
- If the appliance is damaged or malfunctions, turn it off, disconnect it from the power supply and contact Blueair.
- The power plug must be firmly inserted in the power socket.
- When disconnecting the unit from the power supply, do not pull on the power cord, pull on the power plug.
- Use the grounded power cable provided with your Blueair air purifier to plug directly and firmly into an appropriate, grounded electrical outlet. Refer to the rating label on your appliance.
- Do not use an extension cord or a power strip. Refer to the rating label on your appliance.

- Do not alter the power plug in any way.
- Do not use the included power cord for anything else but the appliance.
- Do not allow objects to enter or block the air inlets and air outlets as this can cause electric shock or damage the appliance.
- Do not place any objects on top of or directly against the appliance.
- Do not sit on, stand, climb onto or hang from the appliance.
- Keep the appliance, including the power cable, at a safe distance from heated surfaces and open fire.
- Keep the appliance and power plug away from water and other liquids.
- Keep the appliance and power plug away from chemicals such as pesticides and deodorants.
- Place the appliance on the floor. The appliance must be placed on a stable surface.
- Do not use the appliance outdoors or in wet environments such as bathrooms, laundry rooms or pool areas.
- Cleaning and user maintenance shall not be made by children without supervision.

# Get started

## Step 1

Open the filter door, pull out the main filter and remove the protective wrapping.

## Step 2

Put the main filter back into the air purifier and close the filter door.

See section Filters for more information regarding filter handling.

## Plug into the power supply

### Step 1

If your air purifier has a removable power cable, plug the cable firmly into the power cable socket on the air purifier.

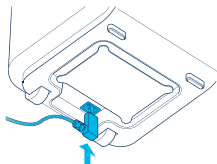

### Step 2

Plug the power cable into a grounded wall outlet.

### Step 3

Press the On/Off button to turn the air purifier on.

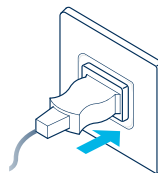

**Note!** For some markets, the air purifier is equipped with a fixed power cable due to regulatory requirements.

**Tip!** Store any excess cable length in the cable winder under the air purifier. (Not applicable for 7300-series).

## Connect to the Blueair app

Connecting the air purifier to the Blueair app allows you to control the air purifier remotely and change the settings. The app adds additional functions to the air purifier.

### Step 1

Download the Blueair app from the App store or Google play.

### Step 2

Open the Blueair app and follow the instructions to connect it to the air purifier.



# Control panel

All Protect models have controls, a filter indicator and air quality information. The 40-models and the 70-models have additional indications for air quality data. The 40-models have a display for particulate matter data. The 70-models have a dynamic screen control, with additional functions for particles, gases (tVOC), temperature, relative humidity and filter lifetime.

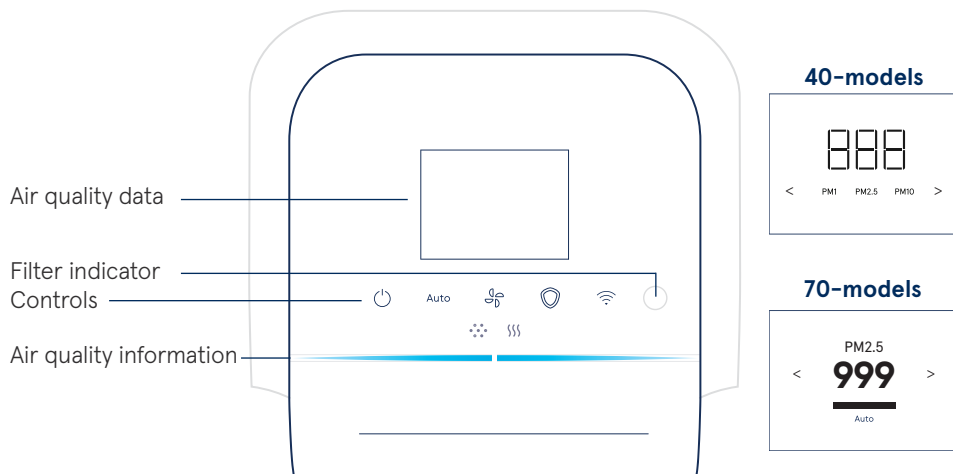

## Controls

Control the air purifier using the buttons on the control panel or using the Blue air app.



On/Off

Auto

Auto mode



Airflow speed



GermShield™



Wi-Fi

---

## On/Off



Press to turn On or Off.

**Note!** Wi-Fi, sensors and the GermShield™ function continue to be in operation when the air purifier is turned off.

## Auto mode

In auto mode the air purifier automatically controls the airflow based on air quality information from the sensor.

**Auto** Press to Activate or Deactivate.

### Indicators 10-models/40-models



Status White light  
On.



Status No light  
Off.

### Indicators 70-models

Auto 

Status checkmark  
On.

Auto 

Status cross  
Off.

## Night mode

In Night mode the air purifier runs on low fan speed and the control panel is dimmed.

**Auto** Press Auto button for 3 seconds to activate Night mode.

To go out of Night mode, press any active button on the control panel.

## Airflow speed

Available airflow speed options are: 1, 2, 3 and 0.



Press to switch between the different airflow speeds.

### Indicators 10-models/40-models



### Indicators 70-models



## GermShield™

The air purifier has a GermShield™ function that activates when a germ-prone environment is detected. The 70-models have an additional indicator on the screen for showing when the GermShield™ function is in operation.



Press to Activate or Deactivate.

### Indicators 10-models/40-models

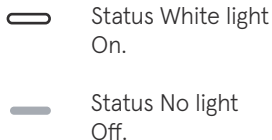

### Indicators 70-models

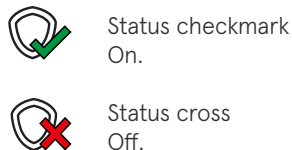

**Note!** When GermShield™ is activated, a light draft can come from the air purifier when detecting a germ prone environment.

## Wi-Fi Connection

A Wi-Fi function is available on all models and allows the air purifier to connect to the Blueair app and to receive functional updates. If you do not wish to be connected to Wi-Fi, press the Wi-Fi button to disable the Wi-Fi function.

### Button



Press for >15s to turn Wi-Fi on or off.

### Indicators (10-models and 40-models)



Status White light  
Connected to Wi-Fi network.



Status White fast "blinking" light  
Failed to connect.



Status White "pulsating" light  
Wi-Fi On, ready for onboarding.



Status No light  
Wi-Fi functionality Off.

### Indicators LCD screen (70-models)



Status Green checkmark  
On.



Status Red cross  
Off.



Status Red exclamation  
Connection error.

### Indicators Buttons (70-models)



Status White light  
Connected to Wi-Fi network.



Status White "pulsating" light  
Wi-Fi On, ready for onboarding.



Status dimmed light  
Wi-Fi functionality Off.



Status White fast "blinking" light  
Connection error.

See the Blueair app for further information regarding Wi-Fi connection.  
For support, visit [www.blueair.com/customer-support](http://www.blueair.com/customer-support)

## Filter indicator

The air purifier calculates the remaining lifetime of the filter based on usage and sensor readings, and indicates when it is time to replace the filter.

### Indicators (10-models and 40-models)



Status Filter replacement  
No lifetime left of the filter.



Status Filter replacement "blinking"  
Cannot recognize a Blueair filter  
/No filter detected.

### Indicators (70-models)



Status Filter replacement  
No lifetime left of the filter.



Status New filter  
Filter change completed.



Status Filter warning  
Cannot detect a Blueair filter.



Status No filter  
No filter detected.

See Troubleshooting for more information on filter indicators.

### Category indicators (40-models and 70-models)

The categories of the different functions are indicated on the top of the screen- press the buttons on the control panel or on the left and right arrow to view the data for the chosen category.

PM1

Particle data



Gas data



Temperature



Filter lifetime



Relative humidity

## Air quality information

The air quality levels for particulate matter (PM) and gases (tVOC) are indicated using a color scale on the control panel.

PM1 Particulate matter, particles with diameter of size 1 micrometer or less.

PM2.5 Particulate matter, particles with diameter of size 2.5 micrometers or less.

PM10 Particulate matter, particles with diameter of size 10 micrometers or less.

VOC Volatile organic compounds, gases found in both outdoor and indoor air.

### Indicators



Particulate matter indicator



Gases (tVOC) indicator

### Air quality level

The air quality indicator bar for particles will show the highest pollution level out of PM1, PM2.5 and PM10.

	Very Polluted
	Slightly Polluted
	Moderate
	Good
	Excellent
	Data not available

See the Blueair app for further information regarding air quality.

## Air quality data 40-models and 70-models

The 40-models have an additional display that shows measured values for PM1, PM2.5 and PM10. Press the left or right arrow to switch between the different particulate matter sizes.

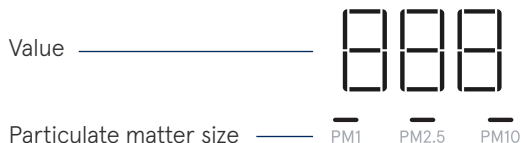

### Indicators

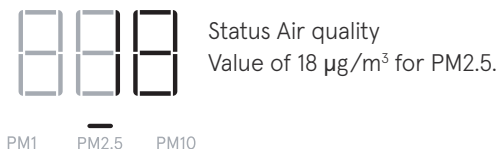

The 70-models have a dynamic screen control that shows additional values and statuses for different categories, and have additional indications to show active functions. Press the left or right arrow to switch between the different categories.





### Particle data indicator

The air quality data for particles are indicated on the screen. Press the left or right arrow to switch to the Particle data category page. The screen shows measured values for PM1, PM2.5 and PM10, with its related air quality information indicated in the status bar.

PM1

5

Category PM1  
Value of 5  $\mu\text{g}/\text{m}^3$ .  
Status Excellent air quality.

PM2.5

15

Category PM2.5  
Value of 15  $\mu\text{g}/\text{m}^3$ .  
Status Good air quality.

PM10

55

Category PM10  
Value of 55  $\mu\text{g}/\text{m}^3$ .  
Status Moderate air quality.



Loading data  
/No data available.

See the Blueair app for more information.

### Temperature indicator

The room temperature is indicated on the screen. Press the left or right arrow to switch to the Temperature category page.



17°C

Category Temperature  
Value of 17 degrees Celsius/63 degrees Fahrenheit in the room.

### Relative humidity indicator

The relative humidity of the room is indicated on the screen. Press the left or right arrow to switch to the Relative humidity category page.



36%

Category Relative humidity  
Value of 36% in the room.

## Gas data indicator

The air quality data for gases (tVOC) is indicated on the screen. Press the left or right arrow to switch to the Gas data category page. The screen shows the different sensor readings of gases over time.

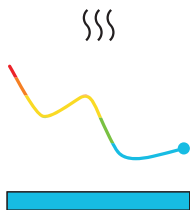

Category Gas data

Value of air quality levels for gases (tVOC) in the room over time.

Status Excellent air quality.

## Filter lifetime indicator

The remaining lifetime of the filter is indicated on the screen. Press the left or right arrow to switch to the Filter lifetime category page. The air purifier will count down from 100% with a new filter, and indicate when it is time to change filter.



Category Filter lifetime

Value of 90% left of the filter.

Status bar counting down.



Category Filter lifetime

Value of 9% left of the filter.

Status bar counting down.

# Filters

The air purifier is delivered with two pre-filters and one main SmartFilter filter installed. The filters purify the air from both particles and gases. For best performance, clean the pre-filters regularly and change the main filter when the air purifier indicates filter change. To find the correct main filter for your air purifier, use the Blueair app or visit [www.blueair.com](http://www.blueair.com). The model number of your air purifier can be found on the rating label on the air purifier.

## Blueair filter subscription program

Use the Blueair app or visit [www.blueair.com](http://www.blueair.com) to sign up for the Blueair filter subscription program. (Not available in all markets)

**Important!** Always turn off and disconnect the appliance from the power supply before changing filters, cleaning or carrying out maintenance procedures.

## Clean the pre-filters

For best performance, clean the pre-filters regularly.

### Step 1

Push the left or right side frame indent of the air purifier to release the pre-filter.\*

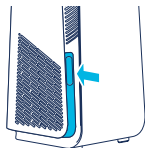

### Step 3

Clean the pre-filter, by wiping with a dust cloth or vacuuming with a soft brush attachment.



### Step 5

Push the pre-filter to lock it in position.

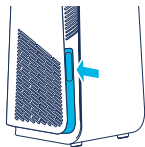

### Step 2

Pull out the pre-filter from the slot.

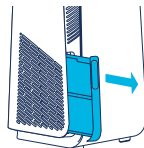

### Step 4

Place the pre-filter back into the slot.

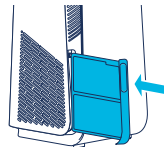

\* For 7300-series: Pull the lower part of the pre-filter towards you to release it.

## Change the main filter

The air purifier calculates the remaining lifetime of the filter based on usage and sensor readings, and indicates when it is time to change filter. The recommended time for filter change is between 6-12 months depending on the indoor conditions.

A filter replacement indicator appears on the control panel when it is time to change filter.



Filter replacement indicator  
**(10-models and 40-models)**



Filter replacement indicator  
**(70-models)**

**Important!** Use only original Blueair filters suitable for the model to ensure proper function and performance of the air purifier.

### Step 1

Open the filter door.

**Note!** The air purifier will turn off when the filter door is opened.

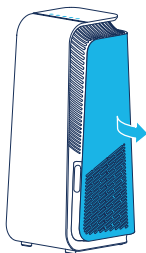

### Step 2

Remove the old main filter by pulling gently on to the two tabs.

Close the main filter to seal the pollutants inside.

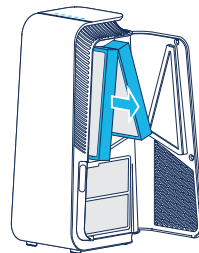

### Step 3

**Note!** Remember to remove the protective plastic from the new main filter before use.

Insert the new main filter.

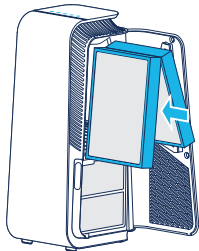

### Step 4

Close the filter door.

**Note!** The filter door needs to be closed for the air purifier to start again.

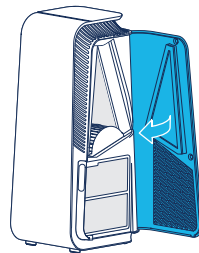

# Move the air purifier

The air purifier has feet and wheels\* to enable moving.

## Important!

- Unplug the air purifier before moving it.
- Make sure that the filter door on the air purifier is securely closed.
- Move the air purifier by holding onto the handle at the top of the air purifier with two hands.
- Move the air purifier by tilting it backwards and rolling it on its wheels.\*

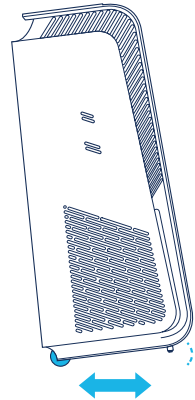

# Cable winder

The air purifier has a manual cable winder\* to store away any excess cable length. The cable winder is at the bottom of the air purifier. Store any excess cable by wrapping it around the cable winder.

\*Not available on 7300 models

# Care and maintenance

## General

- Disconnect the air purifier from the power supply before maintenance.
- Do not allow foreign objects to enter the air inlets or air outlets. This may cause electric shock or damage the air purifier.
- Never clean with gasoline, chemical solvents or corrosive materials as these agents may damage the air purifier.
- Make sure the air purifier is completely dry before connecting it to power.
- Do not wash the main filter. The main filter is not washable or reusable.

## Cleaning

- Clean the pre-filters by wiping with a dust cloth or vacuuming with a soft brush attachment.
- Wipe the exterior of the air purifier with a soft, clean, damp cloth.
- Open the door, clean the inside of the door with a soft, clean cloth.
- Vacuum the small air inlets with a soft brush attachment.
- Vacuum the inside of the air purifier with a soft brush attachment.
- Clean and check the power cable and power plug for wear or damages.
- Clean the sensor when changing the main filter.

## Air quality sensor

The inlet for the air quality sensor is located on the side of the air purifier. Vacuum the inlet with a soft brush attachment.

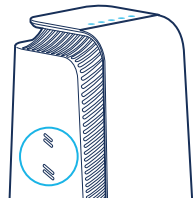

# Troubleshooting

<b>Trouble</b>	<b>Possible cause</b>	<b>Action</b>
The air purifier does not work.	The power cable is not connected to the power supply.	Connect the power cable to the power supply.
	The filter door is not closed on the air purifier.	Gently close the filter door completely.
The connection is not working.	The Wi-Fi does not meet the requirements of the device.	Contact Blueair customer service.
	The Blueair app does not have an updated version or have a temporary bug.	Check for updates.
	The Blueair app has user account issues.	Contact Blueair customer service.
The air purifier is indicating that no data is available.	The sensor values are updating.	Wait 30 seconds for update.
		Disconnect the power cable from the wall outlet and wait approximately five seconds before reconnecting the power cable.
The filter indicator is blinking on the control panel and/or the air purifier has reduced airflow speed /or a filter warning is indicated on the screen.	The main filter, or an original Blueair filter, is not detected.	Insert a main filter and/or check it is inserted properly in the air purifier.
		Change to an original Blueair filter.
The buttons on the control panel are blinking when pressed or the display indicates Child lock (not on all models).	The Child lock function is activated.	Turn off Child lock in the Blueair app.
The air purifier have lost Wi-Fi connection and Child lock is activated in the app.	-	Disconnect the power cable from the wall outlet and wait approximately five seconds before reconnecting the power cable.

For further support, please visit [www.blueair.com/customer-support](http://www.blueair.com/customer-support)

## Disposal and recycling

This air purifier should be disposed or recycled as electrical waste and the filter may be recycled as plastic. If you have questions regarding the disposal and recycling of this air purifier, please contact your local recycling facility for availability or Blueair dealer and ask for the correct method of recycling.

## Help and support

If you have questions about your product, please visit [www.blueair.com](http://www.blueair.com) or contact your local Blueair retailer.

To contact Blueair for personalized support, please visit [www.blueair.com/customer-support](http://www.blueair.com/customer-support)

## Limited warranty information

The Blueair Limited Warranty applies only if the air purifier is installed, used and maintained according to the instructions in this manual.

For warranty conditions visit [www.blueair.com/warranty](http://www.blueair.com/warranty)

### Warranty and returns

If you purchased the air purifier at one of our authorized retailers, please contact the same store to request assistance.



# Specification

	<b>7300-series</b>	<b>7400-series</b>	<b>7500-series</b>	<b>7700-series</b>
Input voltage, Frequency	100-240VAC, 50/60Hz	120VAC, 60Hz	120VAC, 60Hz	120VAC, 60Hz
Power consumption <sup>1</sup>	39W	48W	62W	76W
Sound level (min-max) <sup>2</sup>	24dB(A)- 46.55dB(A)	25dB(A)-45dB(A)	25dB(A)-49dB(A)	27dB(A)-55dB(A)
Recommended room size <sup>3</sup>	28 m <sup>2</sup> /310 ft <sup>2</sup>	38 m <sup>2</sup> /418 ft <sup>2</sup>	51 m <sup>2</sup> / 550 ft <sup>2</sup>	62 m <sup>2</sup> /674 ft <sup>2</sup>
CADR Smoke <sup>3</sup>	200 cfm/335 m <sup>3</sup> /h	270 cfm/455 m <sup>3</sup> /h	355 cfm/603 m <sup>3</sup> /h	435 cfm/735 m <sup>3</sup> /h
CADR Dust <sup>3</sup>	200 cfm/335 m <sup>3</sup> /h	275 cfm/465 m <sup>3</sup> /h	355 cfm/603 m <sup>3</sup> /h	>400 cfm/>675 m <sup>3</sup> /h
CADR Pollen <sup>3</sup>	200 cfm/335 m <sup>3</sup> /h	280 cfm/475 m <sup>3</sup> /h	355 cfm/603 m <sup>3</sup> /h	435 cfm/735 m <sup>3</sup> /h

<sup>1</sup> According to UL867:2011

<sup>2</sup> Sound pressure according to GB4214.1-2017

<sup>3</sup>According to ANSI/AHAM AC-1-2019

# Regulatory information

**WARNING:** Changes or modifications to this unit not expressly approved by the party responsible for compliance could void the user's authority to operate the equipment.

**NOTE:** This equipment has been tested and found to comply with the limits for a Class B digital device, pursuant to Part 15 of the FCC Rules. These limits are designed to provide reasonable protection against harmful interference in a residential installation. This equipment generates, uses and can radiate radio frequency energy and, if not installed and used in accordance with the instructions, may cause harmful interference to radio communications.

However, there is no guarantee that interference will not occur in a particular installation. If this equipment does cause harmful interference to radio or television reception, which can be determined by turning the equipment off and on, the user is encouraged to try to correct the interference by one or more of the following measures:

- Reorient or relocate the receiving antenna.  
Increase the separation between the equipment and receiver.
- Connect the equipment into an outlet on a circuit different from that to which the receiver is connected.
- Consult the dealer or an experienced radio/TV technician for help.

This device complies with Part 15 of the FCC Rules. Operation is subject to the following two conditions:

1. this device may not cause harmful interference, and
2. this device must accept any interference received, including interference that may cause undesired operation.

This device contains licence-exempt transmitter(s)/receiver(s) that comply with Innovation, Science and Economic Development Canada's licence-exempt RSS(s). Operation is subject to the following two conditions: (1) This device may not cause interference, and (2) This device must accept any interference, including interference that may cause undesired operation of the device.

This Class B digital apparatus complies with Canadian ICES-003.

FCC/ISED RF Exposure Information: This equipment should be installed and operated with a minimum distance of 20 centimeters between the radiator and your body.